

1625-1790nm High Power 3-Port Circulator

FEATURES

- High Isolation
- Low Insertion Loss
- Epoxy-Free Optical Path
- High Reliability and Stability
- Low Profile Packaging

APPLICATIONS

- Fiber Optic Amplifiers
- Fiber Optic Instruments
- WDM Systems
- Dispersion Compensation
- Light Routing



SPECIFICATIONS

Configuration	Unit	3-port		
Working Wavelength	nm	1625±15, 1650±10, 1700±10, 1730±10, 1750±10		
Insertion Loss	(Typ.)	0.8		
	(Max.)	1.4		
Isolation@23°C	(Min.)	30	20	
Optical Return Loss	dB	≥45		
Cross Talk	dB	≥45		
Polarization Dependent Loss	dB	≤0.20		
Fiber Type	-	SMF-28 Fiber or 10/130um DC Fiber (O) 12/130um DC Fiber (T) or 20/130um DC Fiber (Q) 25/250um DC Fiber (R) or 25/300um DC Fiber (G)		
Fiber Tensile Load	N	5		
Max. Optical Power (CW)	W	1, 2, 3, 5	10, 15, 20	
Operating Temperature	°C	0~50		
Storage Temperature	°C	-40~85		
Package Dimension	Stainless Steel Tube (SST)	mm	∅5.5x50	See Drawing
	Metal Box	mm	L120xW12xH10	

- Note:**
1. Specifications are for device without connectors; Specifications may change without notice.
 2. To add connectors, IL is 0.3dB higher, RL is 5dB lower.
 3. Only guarantee 1W continuous wave (CW) power thru testing for connectors added.
 4. Devices for higher optical power or with other type fiber or consigned fiber are also available; Devices can only work in the core of Double Cladding (DC) Fiber, Cladding Power must be stripped before connecting the device.
 5. Package size may be different for different optical power and fiber types.

PACKAGE DIMENSION (>5W OPTICAL POWER)

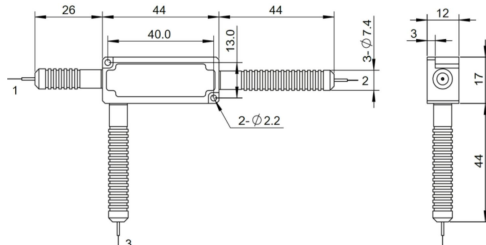

ORDERING INFORMATION (PN)

FCIR- NNNN -3HP NN - (NN) - (C) (C) C NN - CC/CCC	Center Wavelength	Optical Power	Optical Power P2	Package	Fiber Type	Fiber Sleeve	Fiber Length	Connector Type
	1625-1625nm	1-1W	1-1W	M= Metal Box	O=10/130 DC Fiber	B= Bare Fiber	05-0.5m	N= Without Connector
	1650-1650nm	2-2W	2-2W	Blank for SST	T=12/130 DC Fiber	L= Loose Tube	10-1.0m	FC/APC=FC/APC Connector
	1700-1700nm	5-5W	5-5W	or >5W Power	R=25/250 DC Fiber	2=2mm Cable	15-1.5m	LC/PC =LC/PC Connector
	1750-1750nm	10-10W	Blank for P2=P1		Blank for SMF-28 Fiber	3=3mm Cable	20-2.0m	SC/UPC=SC/UPC Connector

