

1070nm High Power Collimating Isolator for Pulse Power

FEATURES

- High Isolation
- Low Insertion Loss
- Epoxy-Free Optical Path
- High Reliability and Stability
- Low Profile Packaging

APPLICATIONS

- Fiber Optic Amplifiers
- Fiber Optic Instruments
- WDM Systems
- Transmitters and Fiber Lasers
- CATV Networks

SPECIFICATIONS

Parameter	Unit	High Power Type
Center Wavelength (λ_c)	nm	1070
Operating Wavelength Range	nm	+/-10
Peak Isolation (Typ.)	dB	28
Min. Isolation (λ_c , 23°C)	dB	20
Typical Insertion Loss	dB	0.50
Max. Insertion Loss	dB	0.75
Min. Optical Return Loss	dB	50
Max. Polarization Dependent Loss	dB	0.15
Fiber Type	-	HI1060 Fiber or 10/125um SC Fiber (E) 10/125um DC Fiber (O), 15/130um DC Fiber (W) 20/130um DC Fiber (Q) or 25/250um DC Fiber (R)
Nominal Output Beam Diameter	mm	0.5, 1, 2, 5 or customer specify
Max. Average Optical Power	W	1, 2, 3, 5 10, 15, 20, 30, 50, 80, 100
Max. Peak Power for Pulse	kW	0.1, 1, 2, 3, 5, 10, 20
Operating Temperature	°C	0~50
Storage Temperature	°C	-20~75

- Note:**
1. Specifications are for device without connectors; Specifications may change without notice.
 2. To add connectors, IL is 0.5dB higher, RL is 5dB lower.
 3. Only guarantee 1W continuous wave (CW) power thru testing for connectors added.
 4. Devices for higher optical power or with other type fiber or consigned fiber are also available; Devices can only work in the core of Double Cladding (DC) Fiber, Cladding Power must be stripped before connecting the device.
 5. Package dimension may be different for different beam diameter.

PACKAGE DIMENSION

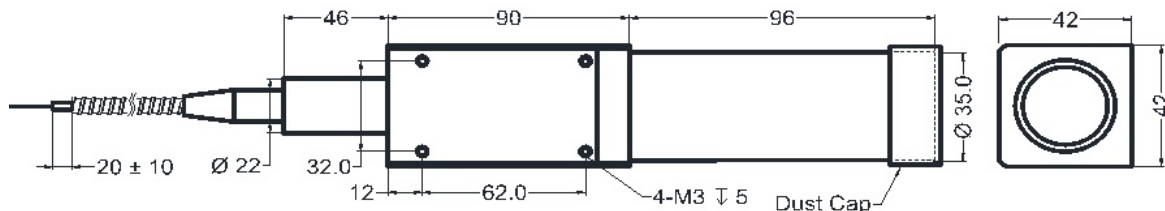

ORDERING INFORMATION (PN)

FISO-	NNNN	-	NN	-H	NN	C	NN	-	(C)	C	NN	-	CC/CCC
Center Wavelength	Beam Diameter		Average Power		Peak Power		Fiber Type		Fiber Sleeve		Fiber Length		Connector Type
1070-1070nm	05- 0.5mm		03-300mW		01-100W		E-10/125um SC Fiber		B=Bare Fiber		05-0.5m		N=Without Connector
	10- 1.0mm		1-1W		1- 1kW		Q=20/130um DC Fiber		L=Loose Tube		10-1.0m		FC/APC=FC/APC Connector
	20-2.0mm		10-10W		5-5kW		R=25/250um DC Fiber		2=2mm Cable		15-1.5m		LC/PC=LC/PC Connector
	50- 5.0mm		100-100W		20-20kW		Blank for HI1060 Fiber		3=3mm Cable		20-2.0m		SC/UPC=SC/UPC Connector