

830-850nm Polarization Insensitive Isolator for Pulse Power

FEATURES

- High Isolation
- Low Insertion Loss
- Epoxy-Free Optical Path
- High Reliability and Stability
- Low Profile Packaging

APPLICATIONS

- Fiber Optic Amplifiers
- Fiber Optic Instruments
- WDM Systems
- Transmitters and Fiber Lasers
- CATV Networks

SPECIFICATIONS

Parameter	Unit	Value
Center Wavelength (λ_c)	nm	830, 850
Working Wavelength	nm	+/-10
Peak Isolation (Typ.)	dB	28
Isolation (23°C)	dB	≥ 23
Insertion Loss (Typ, λ_c , 23°C)	dB	1.0
Insertion Loss (Max, 23°C)	dB	1.6
Optical Return Loss (Input/Output)	dB	50/50
PDL	dB	≤ 0.15
Fiber Type	-	HI780 Fiber or 780-HP Fiber
Fiber Tensile Load	N	5
Maximum Optical Power	W	0.3, 0.5, 1, 2, 3, 5, 10, 15, 20
Max. Peak Power for Pulse	kW	0.1, 1, 2, 3, 5, 10, 15, 20
Operating Temperature	°C	0~50
Storage Temperature	°C	-20~75

- Note:**
1. Specifications are for device without connectors; Specifications may change without notice.
 2. To add connectors, IL is 0.7dB higher, RL is 5dB lower.
 3. Only guarantee 1W continuous wave (CW) power thru testing for connectors added.
 4. Devices for higher optical power or with other type fiber or consigned fiber are also available.

PACKAGE DIMENSION

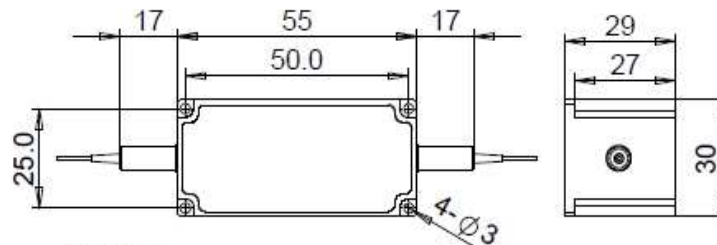

ORDERING INFORMATION (PN)

FISO- NNN	-H NN	P NN	- (C)	C	NN	- CC/CCC
Center Wavelength	Average Power	Peak Power	Fiber Type	Fiber Sleeve	Fiber Length	Connector Type
830-830nm	03=300mW	01=100W	7=780HP Fiber	B=Bare Fiber	05=0.5m	N=Without Connector
850=850nm	2=2W	1=1kW	Blank for HI780 Fiber	L=Loose Tube	10=1.0m	FC/APC=FC/APC Connector
	5=5W	5=5kW		2=2mm Cable	15=1.5m	LC/PC=LC/PC Connector
	20=20W	20=20kW		3=3mm Cable	20=2.0m	SC/UPC=SC/UPC Connector